

OPPEIN

OPPEIN HOME GROUP INC.

Add: #366, Guanghua 3rd Road, Baiyun District, Guangzhou, China

www.oppeinhome.com

+86-20-36730513

sales@oppein.com

[f](#) [in](#) [@](#) Oppein Home



360° Kitchen Showroom



360° Bathroom Showroom



360° Door Showroom



20
22

OPPEIN

KITCHENS
The World's Largest Cabinetry Manufacturer



CONTENTS

- 001** 2022 New Arrival
- 025** Modern
- 035** Minimalism
- 043** Industrial
- 065** Entry Luxury
- 079** Nordic
- 083** European Minimalism
- 087** American
- 089** Classic



ABOUT OPPEIN

Founded in 1994, OPPEIN is China's No.1 kitchen and customized home décor brand, and the world's largest cabinetry manufacturer. We design and manufacture high-quality kitchens, wardrobes, bespoke home furniture, bathroom products, interior doors, aluminum windows & doors and home furnishing, capable of offering one-stop home décor products and solutions. Output and sales of kitchen cabinet reached 830 thousand sets, ranking No.1 in the kitchen industry.

In 2021, OPPEIN's sales turnover reached USD 3.14 billion, harvesting its consecutive 28th years of growth. Output and sales of cabinets reached 6 million sets, ranking No.1 in the cabinetry industry. Our products have been exported to 118 countries and regions, and the total market value of OPPEIN exceeded 100 billion yuan (USD 15.3 billion) in March 2021.

In overseas markets, what sets us apart from our competitors is our Italy design, European quality, one-stop whole-house products & solutions, and reliable local services.

OPPEIN takes great pride in its extensive franchise distribution system. We have a productive showroom operation model and thoughtful support policies to help the franchisees win. Currently, we have a remarkable number of over 7,200 franchise showrooms worldwide to serve local retail businesses.

The global project business is another importance we attach to. We cooperate closely with builders, developers, contractors, and architects to develop different types of residential and commercial business; up to now, we have completed over 10,000 real estate projects around the globe, including some significant local landmark projects.

We achieve this through our unceasing striving for perfection, and the passion to satisfy an individual's needs for better home décor. Our vision is to make OPPEIN a modern, innovative company respected and loved by the people, held in the highest esteem in China, and emulated around the world.

Where there is home and love, there OPPEIN is.

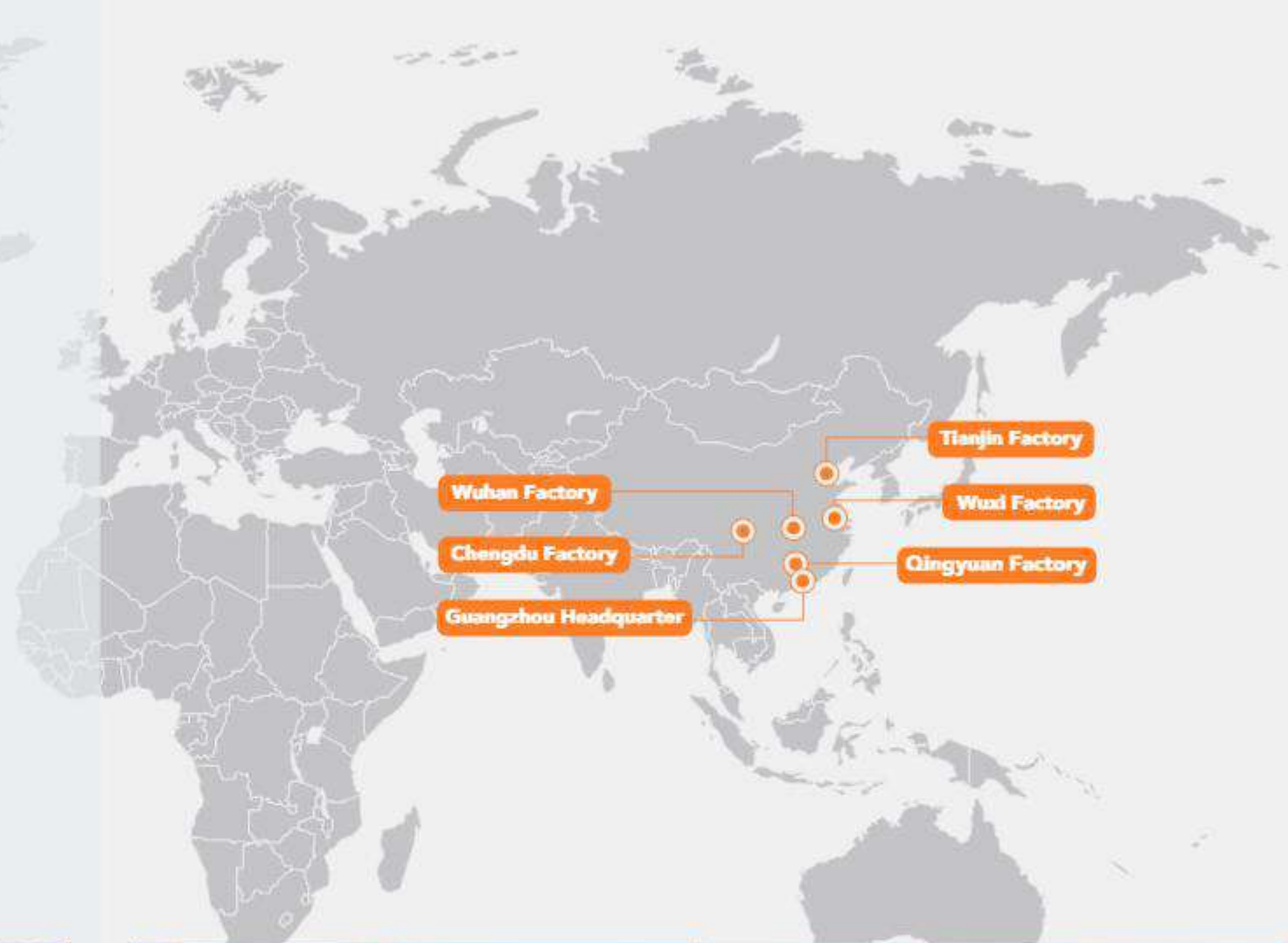

- 1 Guangzhou Headquarter**
Established in 1994, with 444,000m²
- 2 Tianjin Factory**
Established in 2011, with 335,100m²
- 3 Wuxi Factory**
Established in 2015, with 519,400m²
- 4 Qingyuan Factory**
Established in 2017, with 989,300m²
- 5 Chengdu Factory**
Established in 2019, with 496,000m²
- 6 Wuhan Factory**
Under construction, with 507,000m²



1994

Establishment

China's first modern factory to custom make kitchen

1999

Brand Influence

Ranking No.1 both in kitchen sales turnover and brand influence in China

2003

Kitchen Standards

- The first to be selected as "the Drafting Unit of China's Residential Kitchen Standards"
- Setting up its USA office in Boston and starting to explore overseas markets

2009

Guangzhou HQ

- The first to be honored with "China Well-Known Trademark" in the industry
- 1,100+ global showrooms
- Covering a total area of 444,000 SQM, OPPEIN Guangzhou HQ is put into use.

2011

The Largest Cabinetry Manufacturer in Asia

- Tianjin factory with a total area of 335,100 square meters in put into operation
- Becoming Asia's largest cabinetry manufacturer based on both factory size and production capacity

2007

China Top Brand

- The first to be honored with "China Top Brand" in the industry
- 118 exporting countries

2017

Went Public

- Going public in Shanghai Stock Exchange
- Qingyuan factory with a total area of 989,300 square meters is put into operation

2020

Output No.1

Output and sales of kitchen cabinet reached 830 thousand sets, ranking No.1 in the kitchen industry.

Whole house Customization

- China's first to initiate and offer whole-house customization solution
- Setting up offices in India, Philippines, Australia, Kenya and Milan

2014

2015

Wuxi Center

Located in East China, OPPEIN Wuxi manufacturing center, with a total area of 519,400 SQM, is put into use.

2018

6800 Showrooms

- OPPEIN has 6,800+ showrooms worldwide
- OPPEIN has fulfilled 10,000+ real estate projects worldwide ever since 1994

2021

Market Value Breakthrough

- The total market value of OPPEIN exceeded USD 15.3 billion in March 2021.
- Reddot award 2021 winner

COMPANY MILESTONES

China's No.1 Kitchen & Customized Home Decor Brand
The World's Largest Cabinetry Manufacturer.



NIER PLCC22026

Style: Entry Luxury

Door Style: YMN001

Door Finish: Wood Veneer PWMN0005, PWMN0006

Countertop: PWTE0022

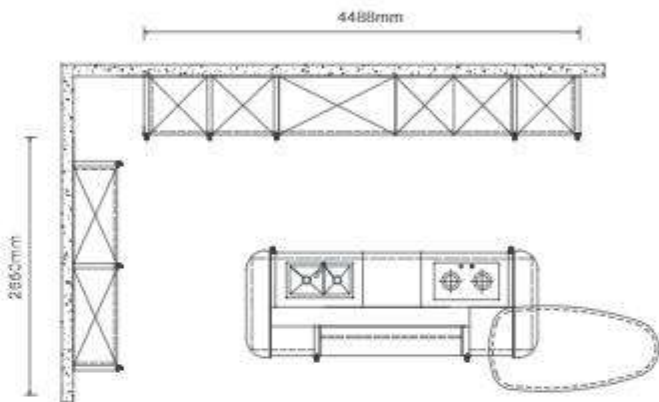



RODIN PLCC22031

Style: Entry Luxury

Door Style: YMN053, YMN054

Door Finish: Wood Veneer PWMN0008, PWMN0009

Countertop: PWTE0005

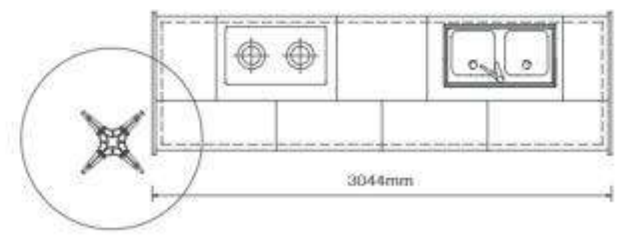
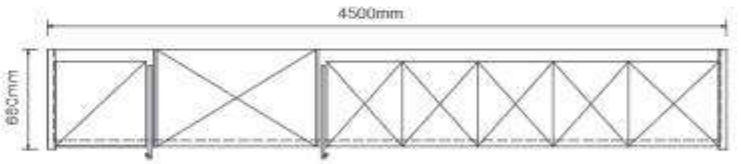

STARTO PLCC22037

Style: Modern

Door Style: YMA079, YMA001

Door Finish: Melamine PWMA0360, PWMA0352

Countertop: PWTE0068

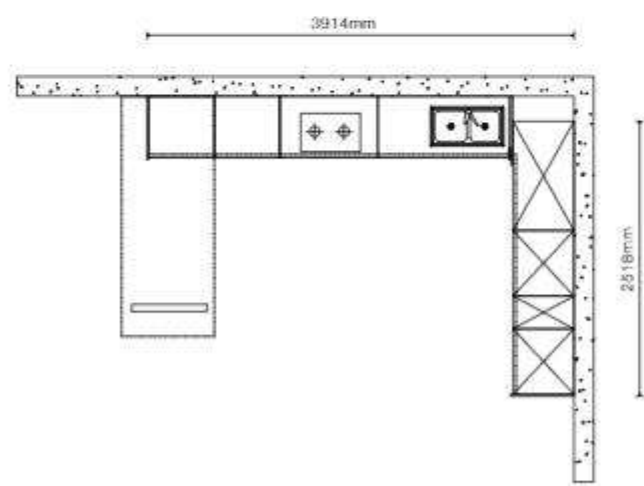



SAMPLE
OPPEIN

CAMON PLCC22046

Style: Modern

Door Style: YMA001

Door Finish: Melamine PWMA0350, PWMA0351, PWMA0215

Countertop: PWTY1092

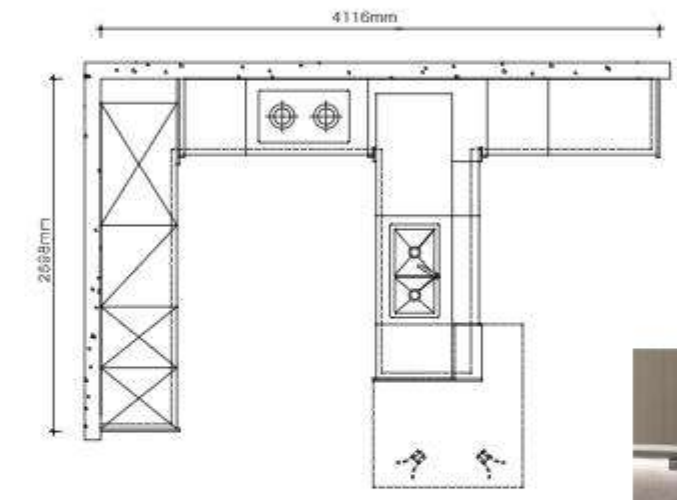

MEDELLIN PLCC22054

Style: Modern

Door Style: YMA001

Door Finish: Melamine PWMA0353, PWMA0354

Countertop: PWTE0049

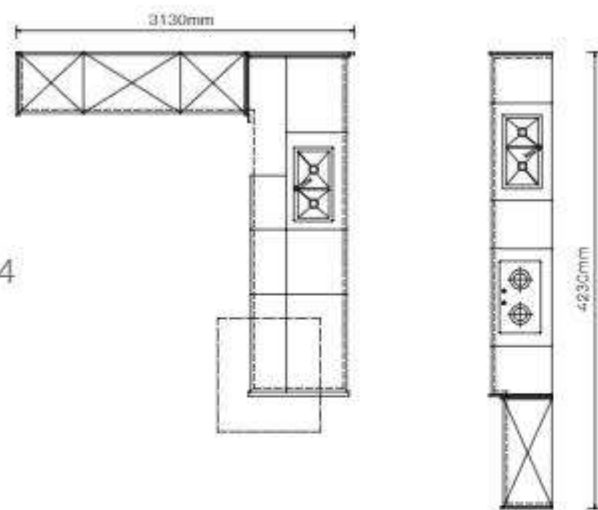



CEZANNE PLCC22092

Style: Modern

Door Style: YMG168, YMG167

Door Finish: PVC PWMG0254, PWMG0255+Melamine PWMA0269

Countertop: PWTE0048

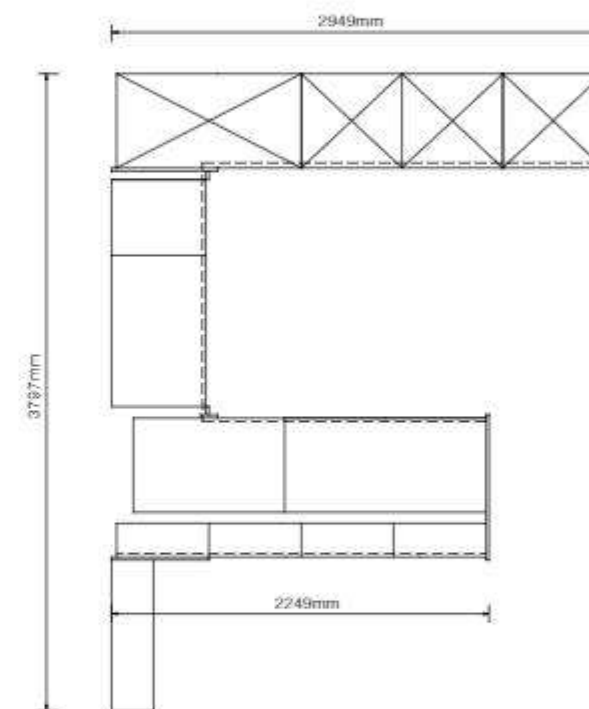

SAMPLE
OPPEIN

BERNARD PLCC22094

Style: Entry Luxury

Door Style: YMG174, YMG175

Door Finish: PVC PWMG0260, PWMG0261

Countertop: PWTE0070

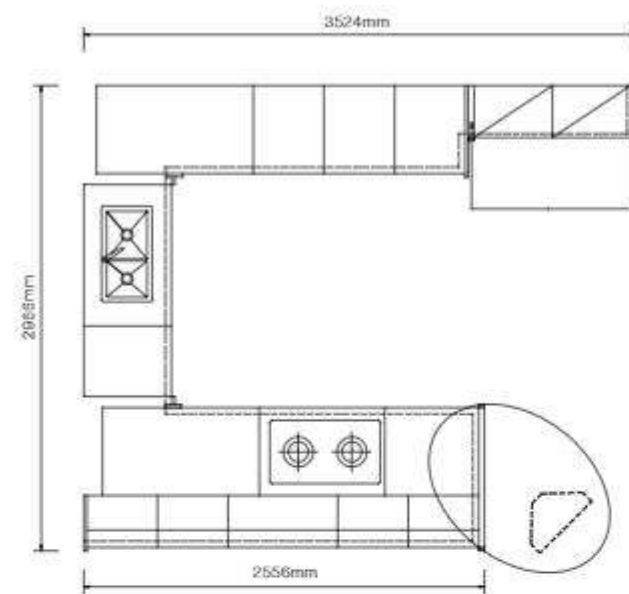

SAMPLE
OFFER



ANNE PLCC22104

Style: Minimalism

Door Style: YMK192, YMK188B, YMG173, YMK188A

Door Finish: Spray Lacquer PWMK7020, PWMG0260

Countertop: PWTE0067

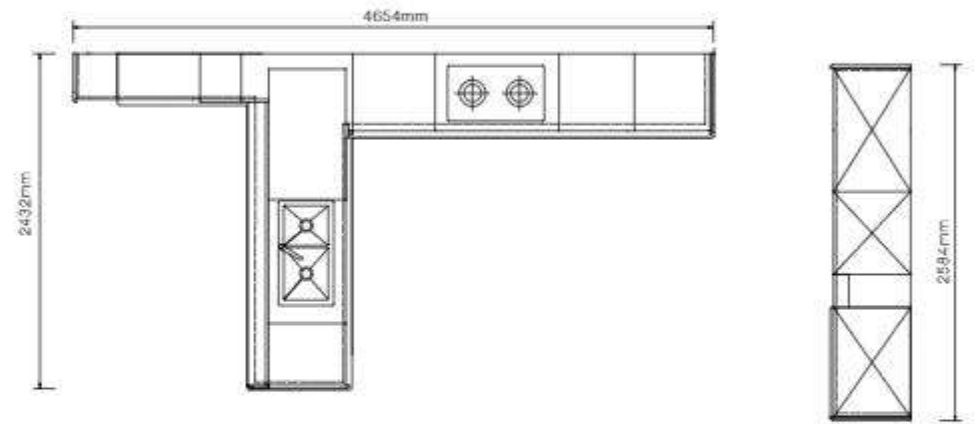

SAMPLE
OPPEIN

BREEZY PLCC22126

Style: Modern

Door Style: YMP001, YMK001

Door Finish: PET PWMP2024, PWMP2025

Countertop: PWTE0067

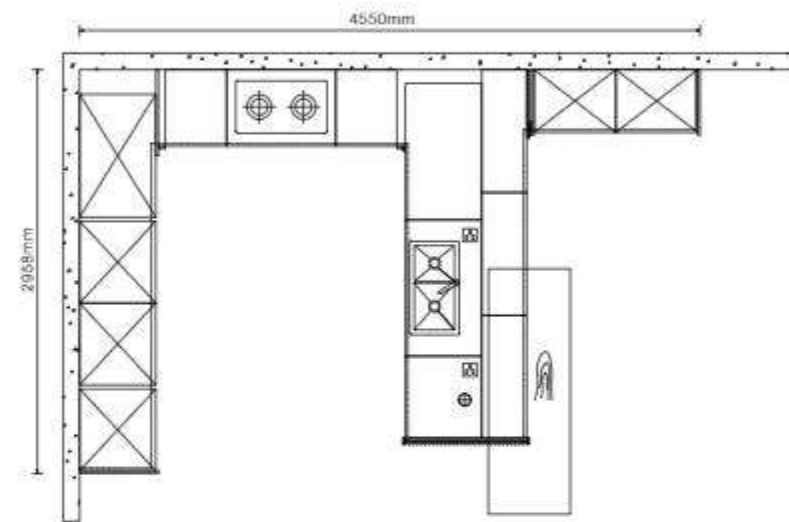

BEIRUT PLCC22194

Style: Entry Luxury

Door Style: YMC003, YMG002, YMA001

Door Finish: UV Lacquer PWMC0112

Countertop: PWTE0031, PWTE0049

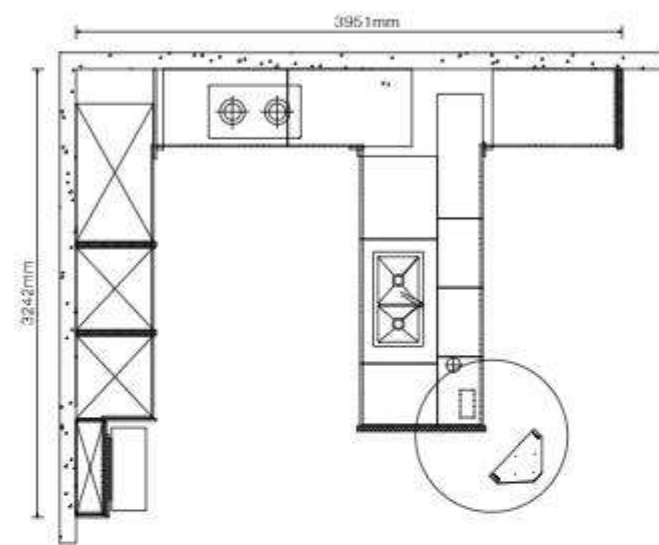

SAMPLE
OPPEIN



STARRY PLCC22195

Style: Entry Luxury

Door Style: YMC003, YMA001

Door Finish: UV Lacquer PWMC0110, PWMC0111+Melamine PWMA0356

Countertop: PWTE0067

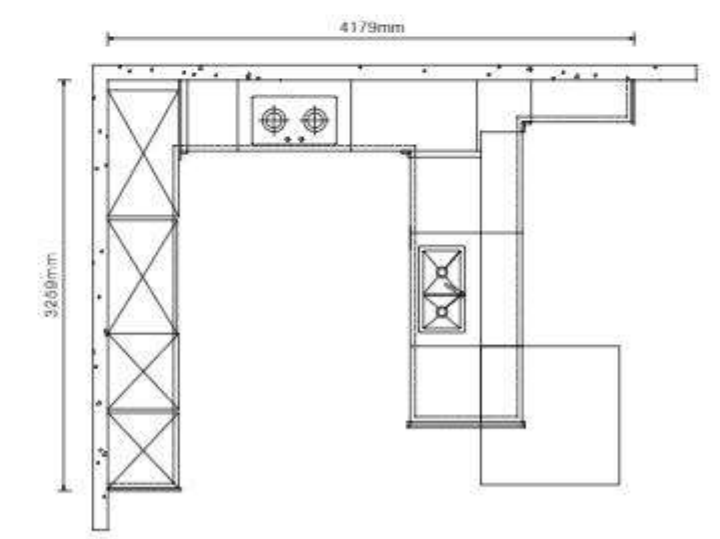

SAMPLE
OPPEIN

TITIAN PLCC22196

Style: Minimalism

Door Style: YMK185A/YMK186A, YMK001G

Door Finish: Spray Lacquer PWMK7006, PWMK7021

Countertop: PWTE0031

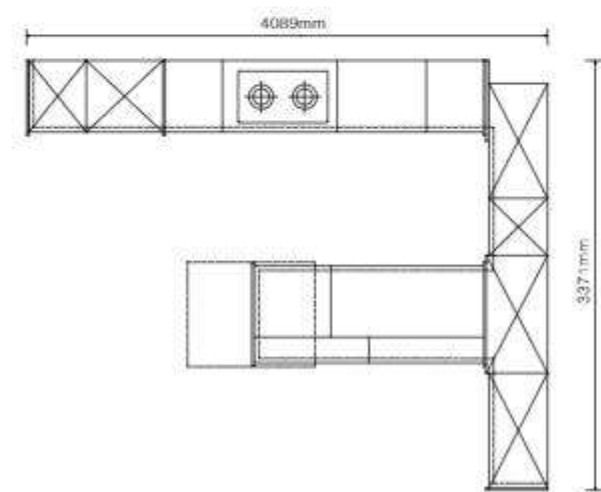



MAGIC Q IV PLCC21405

Style: Modern

Door Style: YMC020, YMC010, YMC003, YMF001, YMA001
 Door Finish: UV lacquer PWMC0081 Countertop: PWTE0008

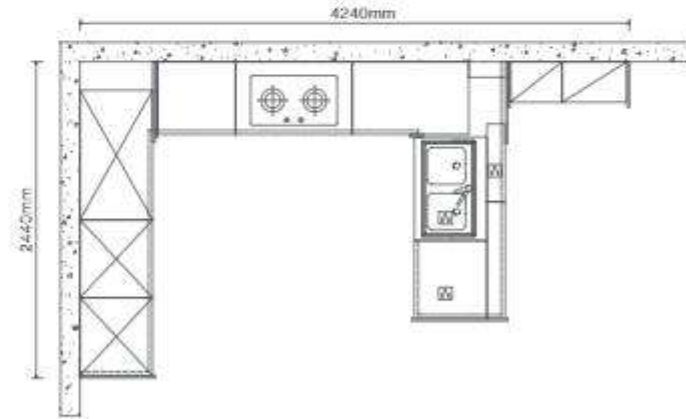

Magic Q IV is designed based on the needs of young generation, post-90s generation in particular. More creative and practical functions are added to it for the sake of comfort and convenience, epitomizing the spirit of pragmatism. Both its social functions and visual appeals are fully developed in this kitchen. It can be adapted for any forms of gatherings and social activities, catering to a new living style among young people.

GLUCK PLCC21412

Style: Modern

Door Style: YMA001

Door Finish: Melamine PWMA0256, PWMA0257

Countertop: PWTY1077



Our relentless pursuit of modernism and minimalism in design, is a tribute to Gluck's attitude towards his music. That is to stay true and simple. Golden oak grain coupled with matte plain stone texture, creates a warm look for the house, add a touch of sophistication and elegance. The company of a good kitchen can restore your mind to tranquility and sedateness.

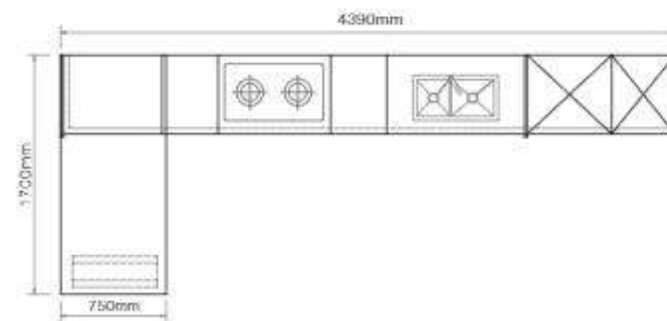



SHERWOOD PLCC21182

Style: Modern

Door Style: YMA009, YMA001

Door Finish: Melamine PWMA0212, BWMA0025

Countertop: PWTY1078

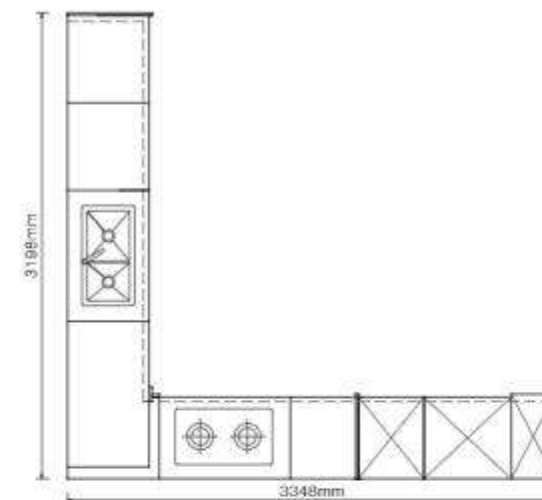

The visual style of Sherwood is a triumph of modern minimalism. Rational layout and divisions together carry out a clean look. Open metal shelves and wall cabinets have come to frame the space, a shade of light grey softening the outline of the kitchen. It is a blend of modernism and extreme simplicity. Pure white units in the middle is an extra stroke to bring a touch of splendour and glamour into the house.





BANDARI PLCC21413

Style: Modern

Door Finish: Melamine PWMA0258, PWMA0259
Countertop: PWTE0034

Metallic blue door panels is in total contrast to the lightness of the grained oak ones, which lends a glaring intensity to the contours of the kitchen. Not only does it highlight the contours of the front faces and lines, but also it depicts the beauty of nature and new modernism. Bandari possesses exquisite qualities that appeal to a refined taste. Living in a house with it, can literally get you into real relaxation the way you would feel when listening to Bandari's piano music, soothing and slow.

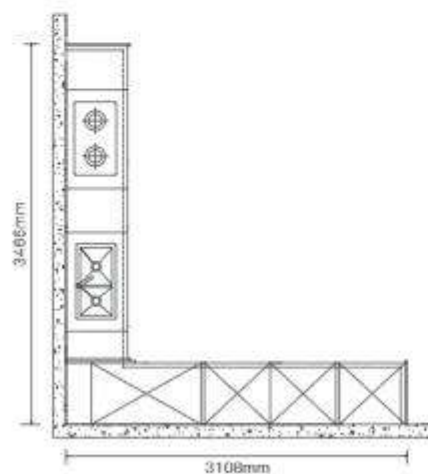



MONT BLANC PLCC18021

Style: Modern

Door Style: YMA001

Door Finish: Melamine PWMA0060, PWMA0103

Countertop: PWTY1032

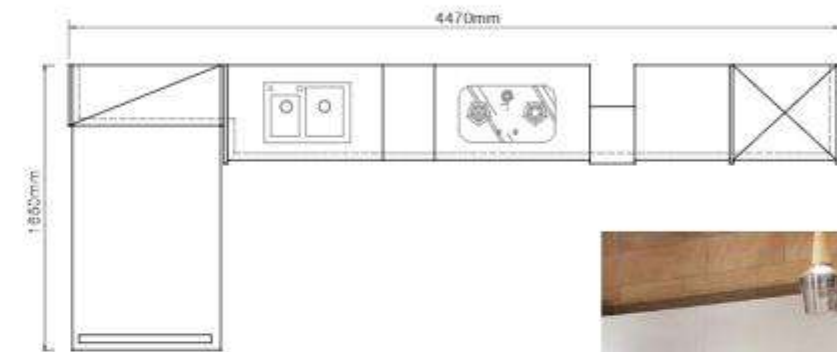

It comes out with its simple layout and a soft shade of color, modern and stylish. This picturesque design has formed a new kitchen concept of exquisiteness, elegance and coziness.



HAYDN PLCC21326

Style: Minimalism

Door Style: YMK143, YMK001

Door Finish: Spray Lacquer PWMK7008

Countertop: PWTE0030

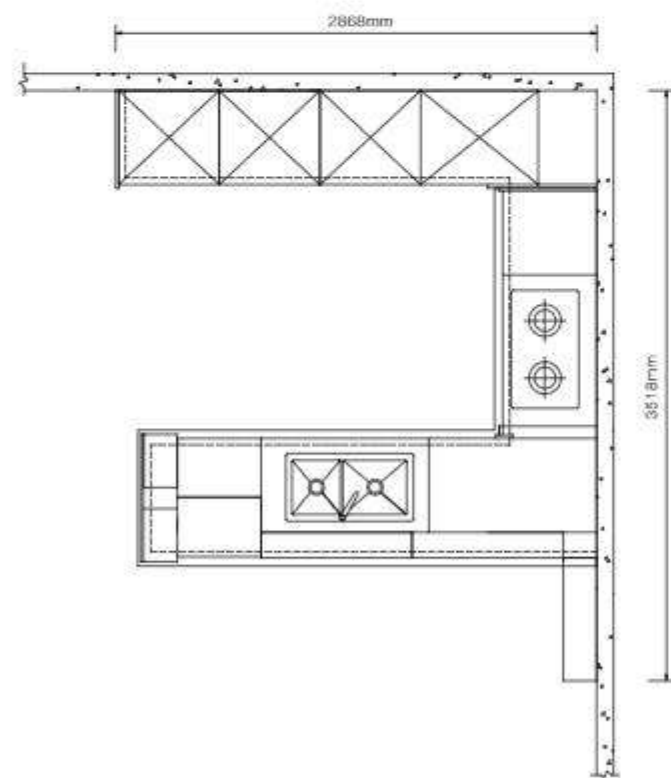



BEAR PLCC20076

Style: Minimalism

Door Style: YMA001

Door Finish: Melamine PWMA0164, BWMA0026

Countertop: PWYT1007

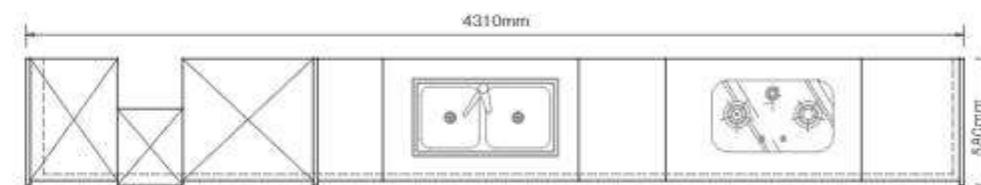

The combination of green and gray is a new visual element of the moment, which is visually pleasing and healing. Gray tone contains a sense of refinement, while moss green color seems as soothing as milk, creating a quiet and comfortable kitchen atmosphere, and offering a place of relaxation.

TIME SQUARE PLCC20094

Style: Minimalism

Door Style: YMG077

Door Finish: PVC PWMG0156, PWMG0156

Countertop: PWTY1048

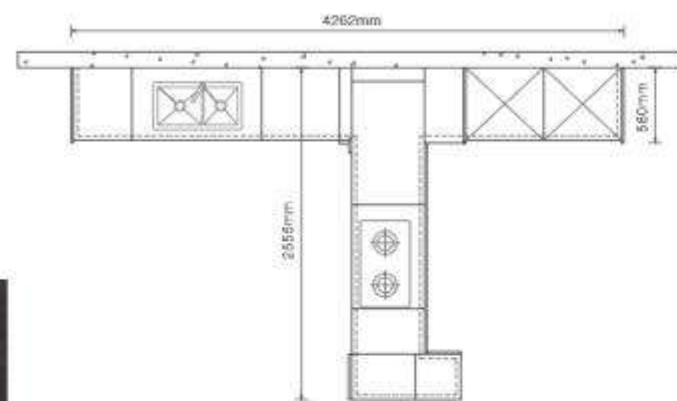

Green is the color that represents life, hope, and vitality. The dark gray void is dotted with patches of green, adding vitality and solemnity into the setting. Under this kind of decoration, it will never be out of fashion since it always creates a peaceful and vibrant atmosphere for home.



SAMPLE
OPPEIN



MOMA PLCC19119

Style: Minimalism

Door Finish: Melamine PWMA0114, PWMA0119

Countertop: PWTY1031

With the state-of-the-art 45° edge-cutting craftsmanship, this handleless kitchen reflects a minimalist lifestyle. The high ribbed glass fronts bring not only a touch to the space, but also showcase the contents elegantly. On the right, the electrical appliances are hidden behind the walnut fronts concisely. Equipped with Australia-made Eclipse sliding door system and when pulled out, the walnut sliding doors can be concealed and discreetly integrated into the wall.

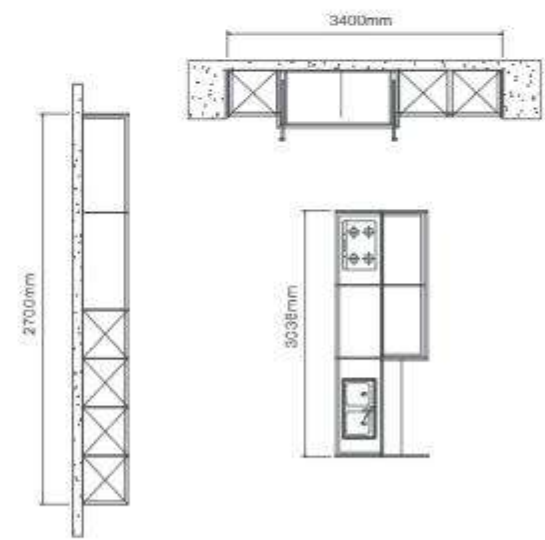



NOTTING HILL PLCC21409

Style: Industrial

Door Style: YMG116, YMG002, YMA001, YMK001

Door Finish: PVC foil PWMG0210, PWMG0209

Countertop: PWTE0022

Notting Hill is another example of a spacious kitchen with PVC coated units and good natural light. Polished surface resonated with titanium golden color tone, just brightens up the room immediately and adds softness to the look. This tends to be more reserved and warm compared to typical industrial styles, allowing it to cover a wide range of interior decorating, being more widely acceptable by people.

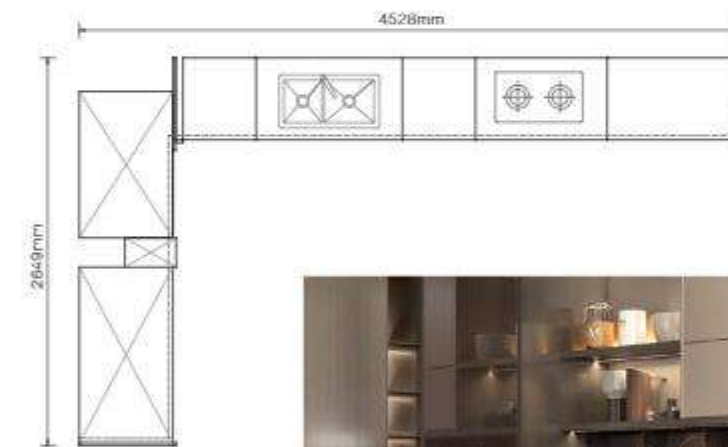

BLUES PLCC21146

Style: Industrial

Door Style: YMA001

Door Finish: Melamine PWMA0217, PWMA0216

Countertop: PWTY1081

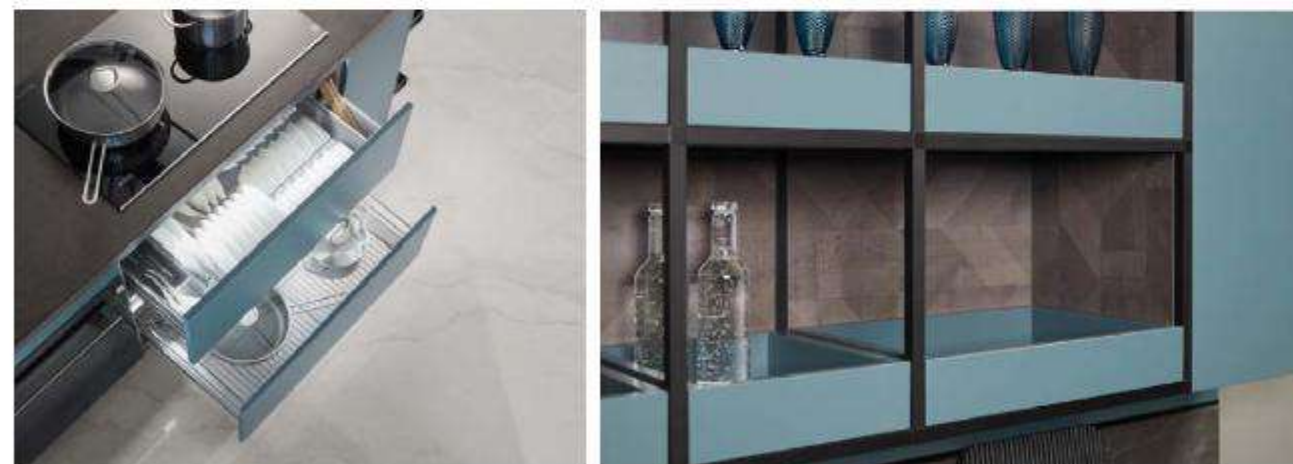
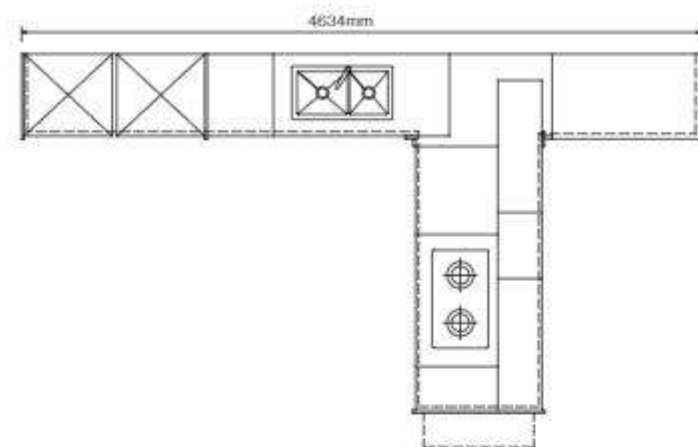



SAMPLE
OPPEIN

LIGHT AND SHADOW PLCC21406

Style: Industrial

Door Style: YMP001, YMP027

Door Finish: PET PWMP2010

Countertop: PWTE0006

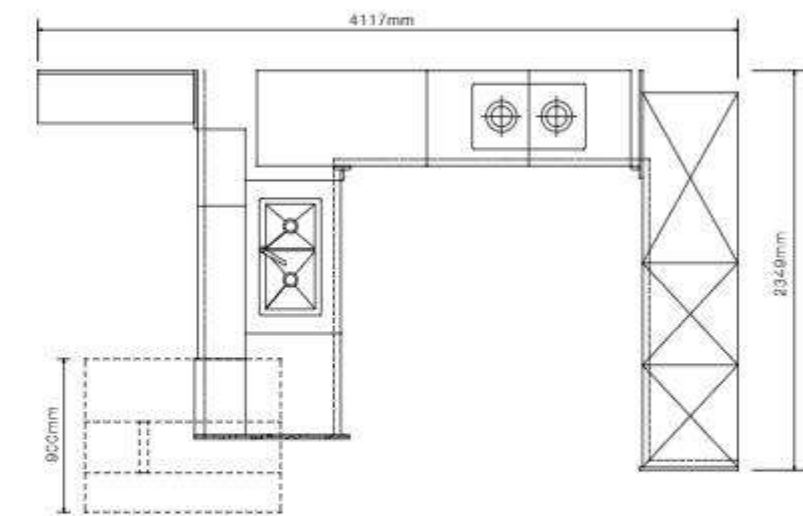

ZEPPELIN PLCC21113

Style: Industrial

Door Style: YMF001

Door Finish: HPL PWMF0064, PWMF0065

Countertop: PWTE0034



The use of stone texture and wood grain texture makes the kitchen more organic as a whole. With the concept of nature introduced into this kitchen design, it reveals a preference for naturalness and simplicity. Various forms of cabinet combination are applied to make full use of kitchen space. Multiple options of materials and lights enable young consumers to embrace a myriad of styles and tastes, with an open attitude to new and experimental ideas.



SAMPLE
OPPEIN

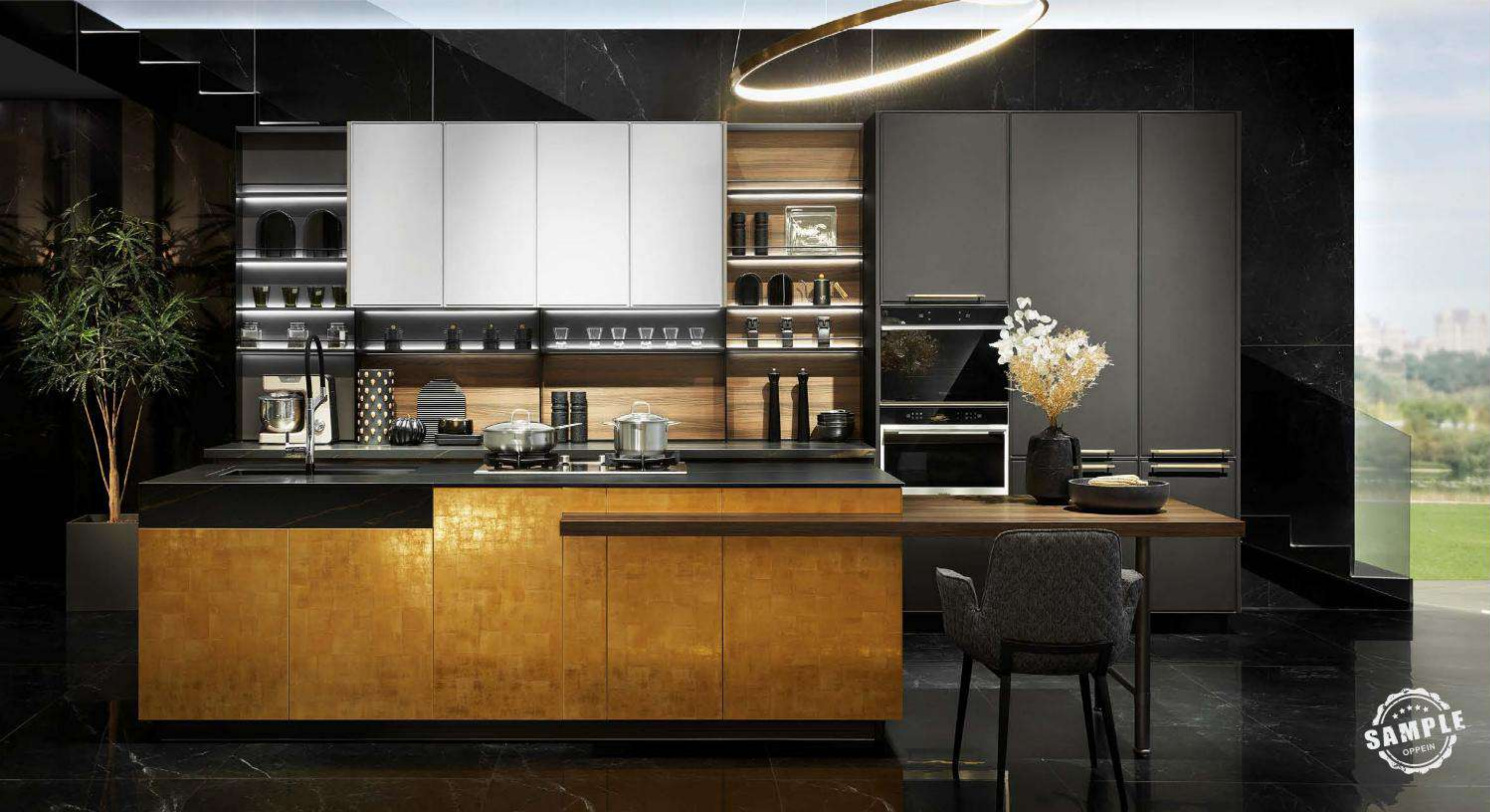

GOLD COAST PLCC20030

Style: Industrial
 Door Style: YMK121
 Door Finish: Spray Lacquer PWMK7001, PWMK7004, PET PWMP2007
 Countertop: PWTE0007

Mixing wood tones and golden color have endowed this kitchen with casual elegance, like the extended dining table and back panel for the open cabinet. Combining with ergonomic principles, we have developed a powerful storage system, which is to use multi-shelves to improve the utilization rate by more than 17%.

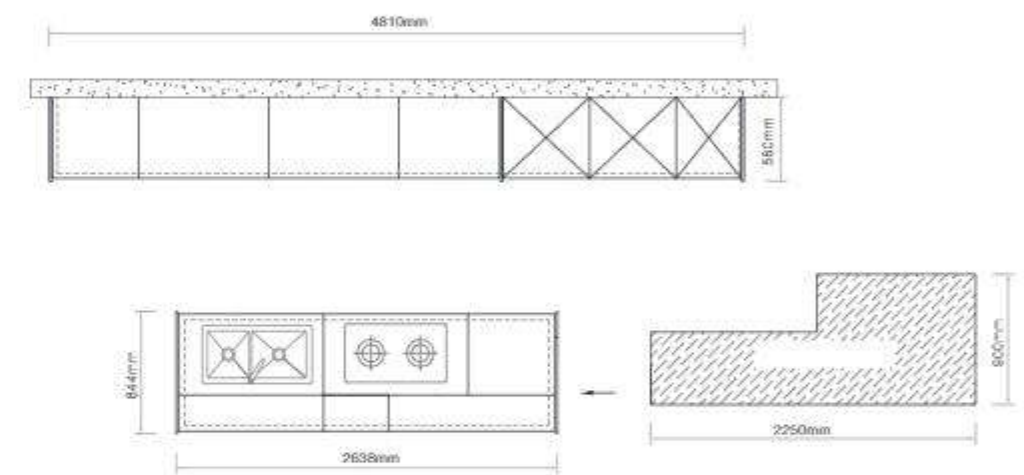

ODE TO JOY PLCC18082

Style: Industrial

Door Style: YMF001

Door Finish: HPL PWMF0047, PWMF0017

Countertop: PWTY1008

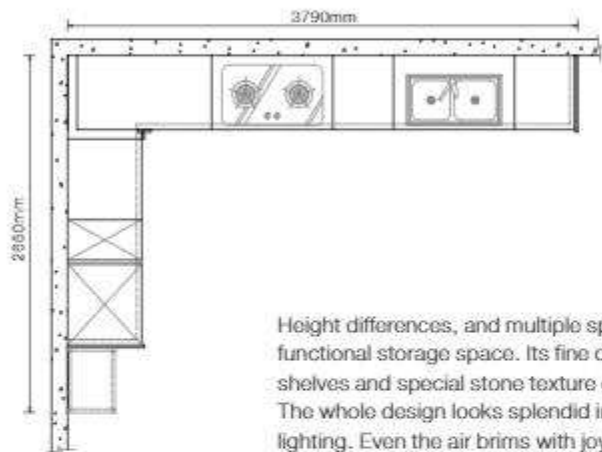

Height differences, and multiple space levels, enable clear divisions of functional storage space. Its fine details including glass doors, metal shelves and special stone texture elements, reveal its striking industrial style. The whole design looks splendid in white, and dazzlingly beautiful with the lighting. Even the air brims with joy and ecstasy.



SAMPLE
ORPEIN



REMINGTON PLCC19019

Style: Industrial

Door Finish: Melamine PWMA0117

Countertop: PWTY1046

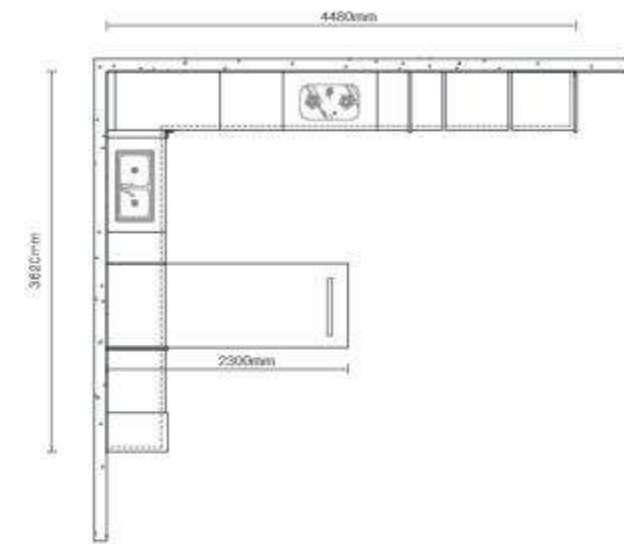

The rusty style door panels have an authentic rock appearance, plus with the black frames and glass fronts, give a distinct industrial feel. The kitchen is perfectly harmonious with the rough interior such as concrete floors and ceilings.

MAGIC-Q III PLCC20108

Style: Industrial

Door Finish: UV Lacquer PWMC0003, Melamine PWMA0136

Countertop: PWTY1048

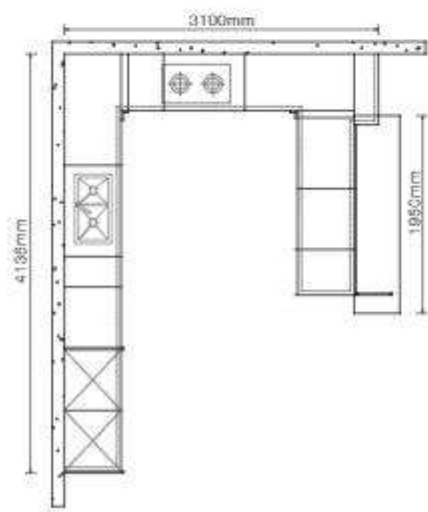

An intense industrial style pops out from the combination of black rock texture and smooth pearlescent white door panel. Simulated rock panels in graceful white color have imparted an air of calmness and elegance. Magic-Q III with its cutting-edge technology just redefine intelligent kitchen for a new era. Using its functional accessories and smart appliances is like opening surprise boxes. It's a kitchen full of magic. You never know what they could lead to.





AURORA PLCC20104

Style: Industrial

Door Style: YMP002, YMA001

Door Finish: PET PWMP2009, Melamine PWMA0061

Countertop: PWTY2014

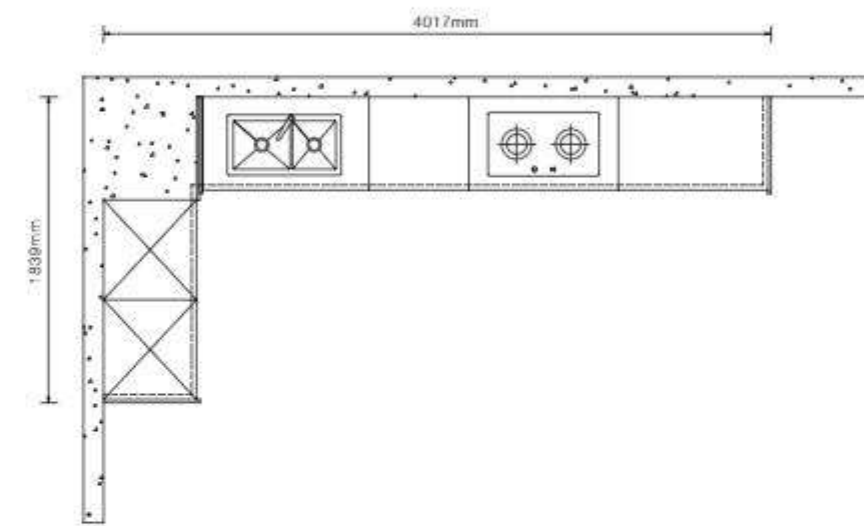

TANGULA PLCC20032

Style: Industrial

Door Style: YMK122A

Door Finish: Spray Lacquer PWMK7005+Melamine PWMA0122

Countertop: PWTE0008

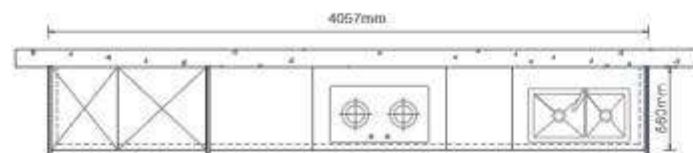

The clean door panel and concealed handle become an integrated design. The design of the unique curved door panel makes the kitchens more beautiful. Simple dark green door panels merged with wood grain back panels, present the Scandi-industrial style perfectly. Brand new lacquer material is not only environmentally-friendly but also practical. And compared to the common lacquer, it's more cost-effective.





HOUSTON PLCC19008

Style: Industrial

Door Finish: Flat Laminate PWMP2005, Metal Foil PWMJ0006

Countertop: PWTY1046

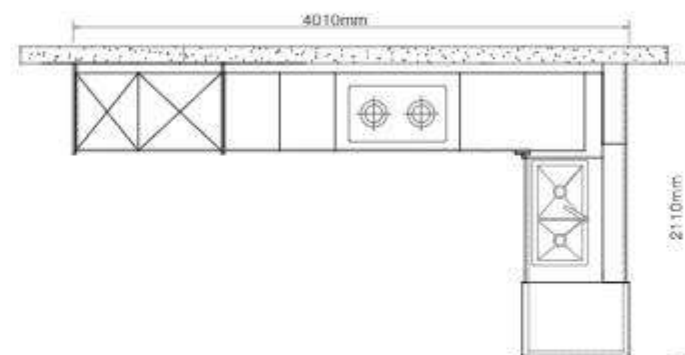

Out of pragmatic concern for high efficiency, this kitchen is designed to adapt to the fast-paced urban life. L-shape layout, presents a clean and tidy look. Functional bar design would allow you to unlock its storage secrets inside. With metal texture, simple lines, proportion and function design, and even the color scheme of metal gray and dark gold, all these elements depict an industrial style, for the sake of convenience and efficiency, so that urbanites can still enjoy the process of cooking at the end of their busy days.



SECRET GARDEN PLCC21043

Style: Entry Luxury

Door Style: YMK148A/B, YMK001, YMK150A/B

Door Finish: Matte Lacquer PWMK5001, PWMK2112

Countertop: PWTE0008

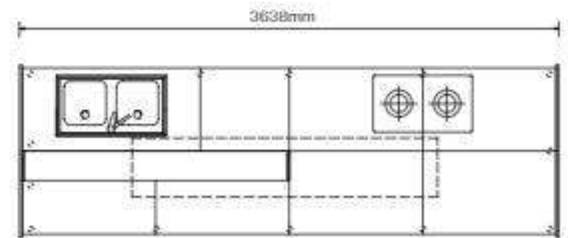
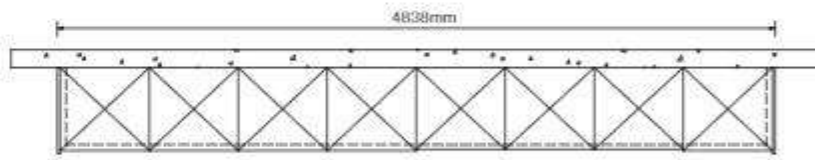

BRESSANON PLCC21340

Style: Entry luxury

Door Style: YMC003, YMC010

Door Finish: UV Lacquer PWMC0063, PWMC0080

Countertop: PWTE0030

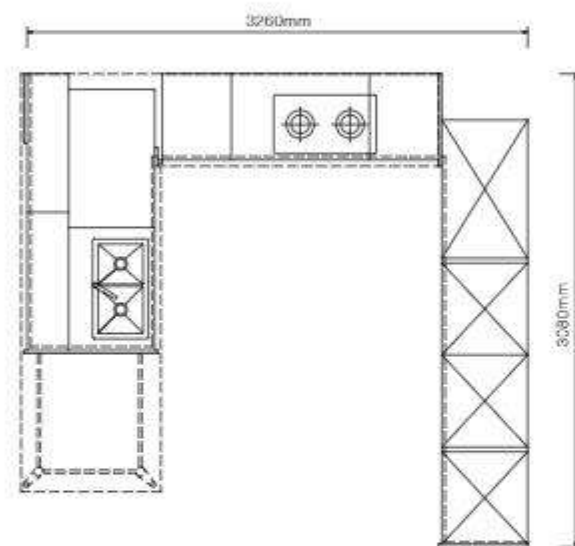



SWAN LAKE PLCC21128

Style: Entry Luxury

Door Style: YMC018, YMK001

Door Finish: UV Lacquer PWMC0061, Lacquer BWMK2011, Melamine PWMA0127

Countertop: PWTY1031

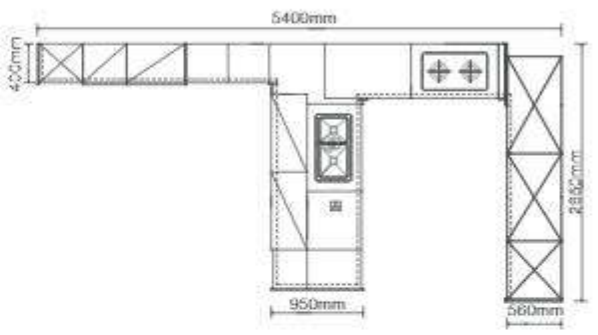

The design idea is drawn from Swan Lake by Tchaikovsky. As a ballerina in white dress, with her black veil, enters a moonlit clearing in the forest, there she dances and rises like a magnificent swan in flight. Her swaying dress has stirred up an ever-widening circle of ripples. Shadow falls on the lake, disperses with water until it finally drifts away into the morning haze. It seems that everything is immersed in an air of tranquility and elegance.



SERENADE PLCC21339

Style: Entry Luxury

Door Style: YMC003/YMC017, YMA001

Door Finish:

UV Lacquer PWMC0060, Melamine PWMA0119

Countertop: PWTE0034

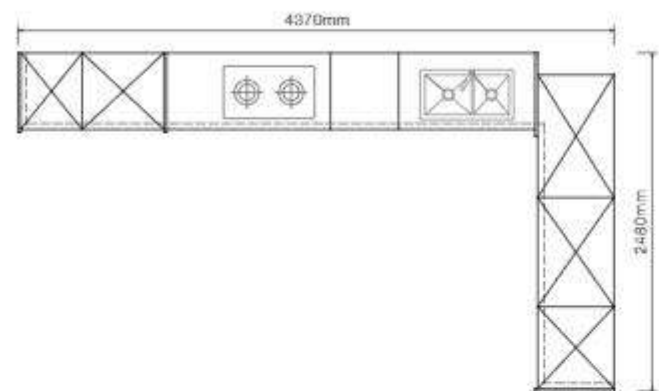

Neutral grey color and wood grain texture is a classical colour combination that manifests an attitude of modesty. Rows of thickened shelves line up with glass doors, bringing about a sense of structure. Minimalism is also emphasized in the fine details such as its narrow wall cabinet system, simple layout and integrated handle design. The image overall produces the impression of coolness and oozes out an ambience of sharpness.





CADDO PLCC21347

Style: Entry Luxury

Door Style: YMC003

Door Finish: UV Lacquer PWMC0064, PWMC0029

Countertop: PWTY1008

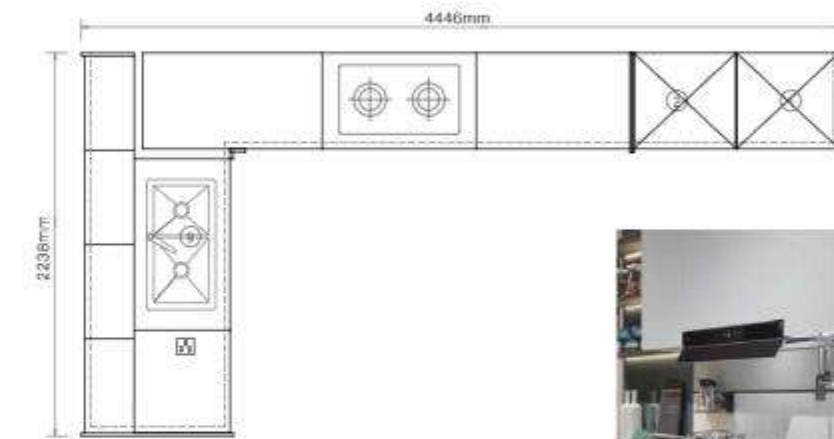

Green and white combine to create a secret forest enveloped in mist. Mirror-like surface reflects lights like sparkling fireflies at night. Also, there are several convenient designs that emphasizes its practicability. It will effectively assist you for cooking or storage with L-shape open design, integrated drawer and rebound door. Such a delightful decor to refresh your home.





ELYSEES PLCC20016

Style: Entry Luxury

Door Style: YMK001, YMC004

Door Finish: Lacquer PWMK1053, UV Lacquer PWMC0032

Countertop: PWTE0005

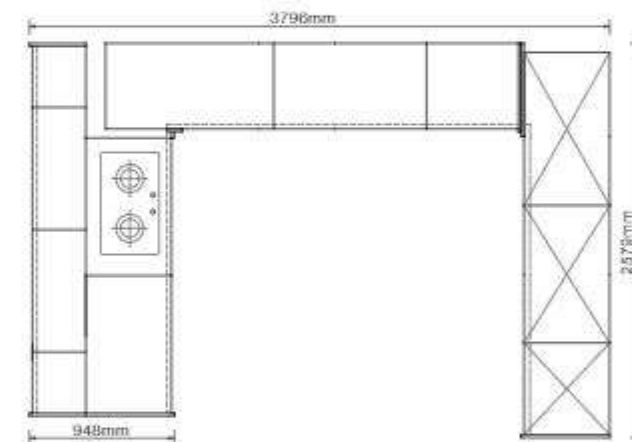

A muted palette of gray lacquer matches the skin-like wood grain texture, and seems harmonious with ultra-narrow aluminum frame in champagne color. A clear and graceful silhouette begins manifesting itself with those simple lines. Stepping into this bright and refreshing kitchen, you may feel as if you were wandering on Avenue des Champs-Élysées, known as world's most beautiful avenue.



MULSANNE PLCC19001

Style: Entry Luxury

Door Style: YMC005, YMA029

Door Finish: UV Lacquer PWMC0015, Melamine PWMA0115

Countertop: PWTY1044

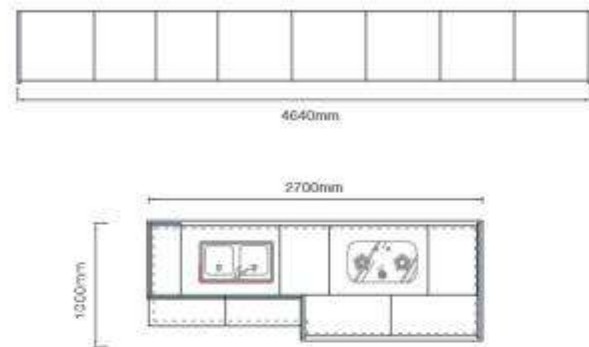

The high gloss rust grey door panels come with clear glass fronts and present an elegant look. Red oak open shelves have fine texture and offer spacious storage with easy accessibility.





MOLLY PLCC20106

Style: Nordic

Door Style: YMC003, YMA001

Door Finish: UV Lacquer PWMC0031, Melamine PWMA0152

Countertop: PWTY1007

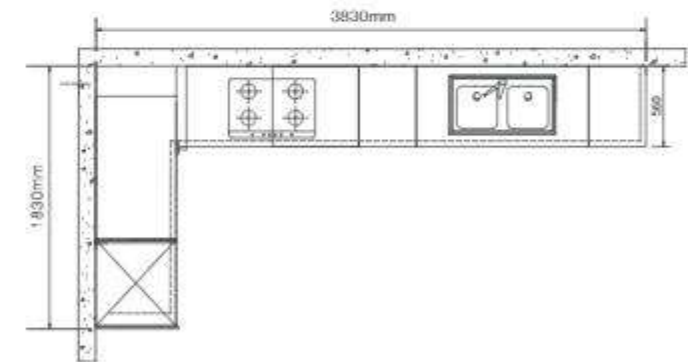



ELLIS PLCC20093

Style: Nordic

Door Style: YMA001

Door Finish: Melamine PWMA0131, PWMA0113

Countertop: PWTY1018

With various space levels and its simple layout set up, stylish wood grain texture and pure white door panels make up a harmonious scene, which conveys a sense of elegance and comfort. Chests of wood grain drawers reinforces its Nordic style. Its wall-mounted system also serves a practical purpose in terms of optimizing the space utilization and enriching its functionalities.

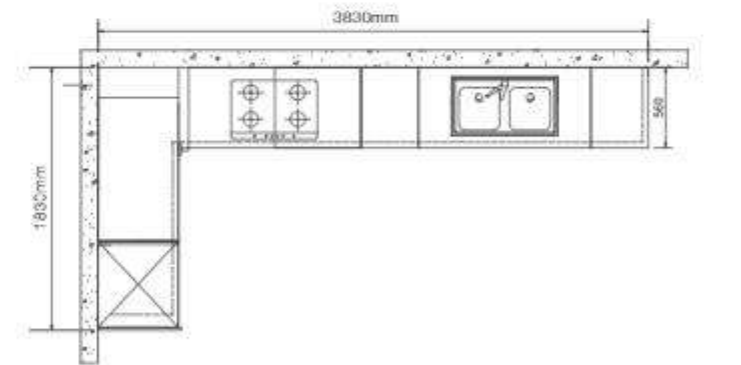



LAKE BAIKAL PLCC18051

Style: European Minimalism

Door Style: YMG058

Door Finish: PVC PWMG0061, PWMG0102

Countertop: PWTY1033

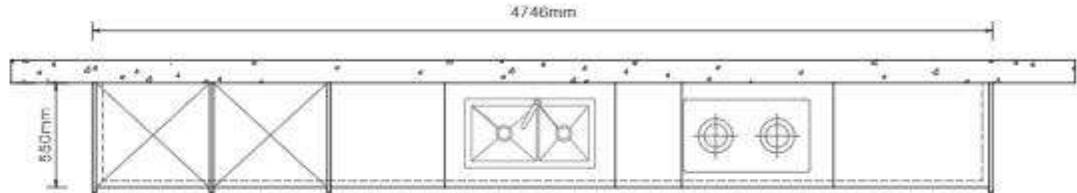

The way blue-gray door panel closely connects with the white ones, looks as if fleecy white clouds and blue lake were echoing each other. The grid door panel of sink cabinet appears refreshing and idyllic. Its simple and elegant appearance, in a perfect proportion, creates a scene of tranquility. The little stylish door decoration enlightens the whole design.



MANZANILLO PLCC20101

Style: European Minimalism

Door Style: YMG088 Door Finish: PVC PWMG0061

Countertop: PWTY1031

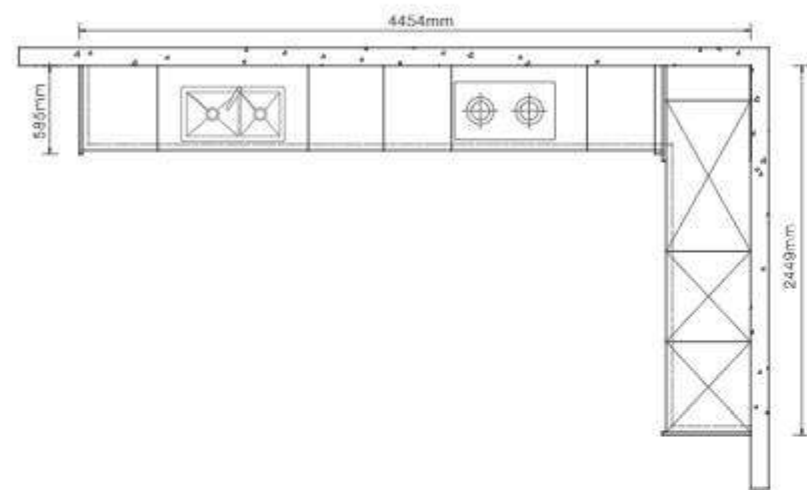

Simple and elegant lines of the doors make the cabinet look clean and graceful, the high-class white material gives it more aesthetic intension, and the striped glass makes it clear and clean. Light white PVC foil matches the brushed brass elements nicely. Exquisite and high-class PVC material with its matt and soft texture could fit a variety of decorative styles.



SAMPLE
OPPEIN



TALES OF AMERICA PLCC19021

Style: American

Door Finish: PVC PWMG0130, Melamine PWMA0113
 Countertop: PWTY1044

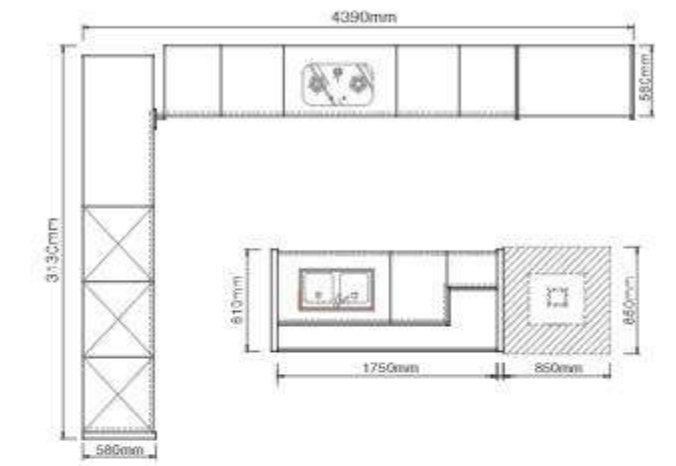

Modern PVC door panel with narrow frame, goes with the exceptionally soft stone texture, brings out its engaging appearance, and highlights its typical American minimalist style in a concise, tidy and neat manner. With white panel reflecting the light, the kitchen looks much brighter and more spacious, creating an ambiance of elegance and warmth. Happiness would linger in every corner of the kitchen when family reunions and parties are held.

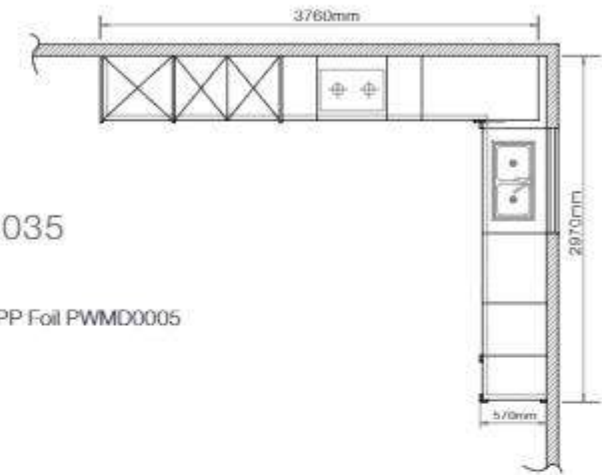

NICAEA PLCC14035

Style: Classic

Door Style: YMD007 Door Finish: PP Foil PWMD0005

Countertop: PWTY1011



People who live in the teeming city now tend to seek a simpler and happier life, clinging to "Back to nature, back to origin" living philosophy. Nicaea is the type of kitchen that every family desires. The antique and delicate solid wood leads you closer to nature, bringing you back to the old times, and casting an air of gentility and elegance to your house.



PREMIUM

CARCASE PANEL | 15mm thick plywood, four edges sealed with 1mm thick PVC.

BACK PANEL | 3mm thick MDF, both faces coated with melamine.

WOODEN SHELF | 15mm thick plywood coated with HPL, front edge sealed with 1mm thick REHAU PVC.

GLASS SHELF | front edge sealed with aluminum, stylish.

DRAWER PANEL | same as carcass panel, edges sealed with 0.6mm thick REHAU PVC.

GLASS SHELF | front edge sealed with aluminum, stylish.

KICKBOARD | material can be aluminum, plastic, HPL, PVC or wood veneer. And colors can be black, silver or white, or customized to be coordinated with doors.



STANDARD | ECONOMICAL

CARCASE PANEL | 16mm thick particle board, four edges sealed with 1mm thick PVC.

BACK PANEL | 3mm thick MDF, both faces coated with melamine.

WOODEN SHELF | 16mm thick particle board coated with melamine, front edge sealed with 1.5mm thick REHAU PVC.

GLASS SHELF | front edge sealed with aluminum.

DRAWER PANEL | same as carcass panel, edges sealed with 0.6mm thick REHAU PVC.

KICKBOARD | material can be aluminum, plastic, HPL, PVC or wood veneer. And colors can be black, silver or white, or customized to be coordinated with doors.

CARCASE PANEL



7-layer Plywood

- ◆ 7 layers solid wood sheets, disperse the stress 40% loading capacity higher than other carcass material.
- ◆ Strong screw holding capacity to keep structure stable and long lasting service.
- ◆ 0.6mm thick laminate on both faces, heat and moisture resistant.
- ◆ Formaldehyde emissions ≤ 1.5mg/L, eco-friendly and complying with European class E1 standard.

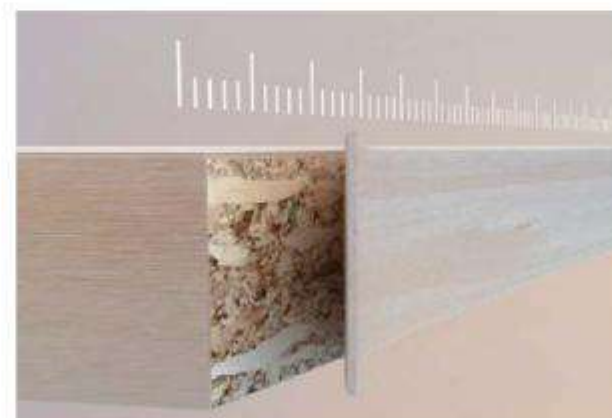

PVC Edging

- ◆ Front edge is sealed with 1.2mm thick PVC by HOMAG edge bander with extreme accuracy and precision while other side edges are sealed with 0.5mm thick PVC.
- ◆ JOWAT eco-friendly seal adhesive to guarantee tight seal and eco-friendliness.



Particle Board

- ◆ Wood chips cold pressed by 300 tons/m² with superior screw holding capacity and load bearing capacity.
- ◆ Keeping stable structure and long lasting service.
- ◆ Easy to clean and protect the carcass from chemical injury.
- ◆ Formaldehyde emissions ≤ 1.5mg/L, eco-friendly and complying with European class E1 standard.

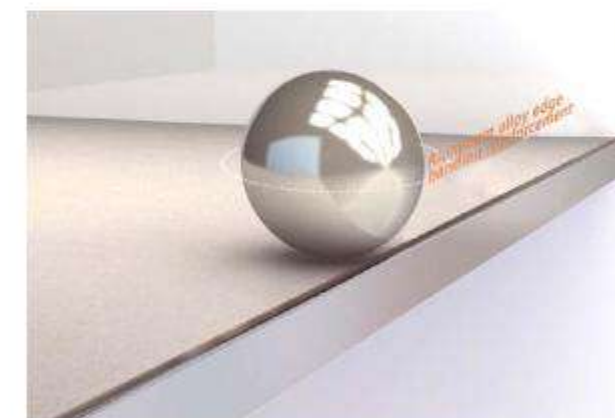

Glass Shelf Edging

- ◆ Glass shelf edge sealed with oxidated aluminum.
- ◆ Vogue and can keep round objects from slipping off.

CARCASE HARDWARE



Top Panel Connector

- ◆ To joint 45° cut crown molding, made from stainless steel.
- ◆ Rustless and extremely durable, allowing tight joints.

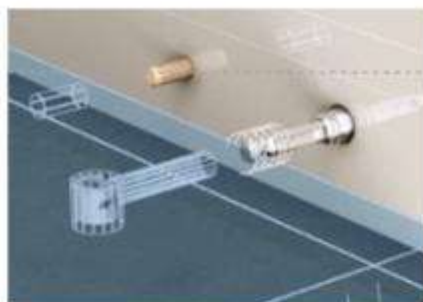

TITUS Quickfit Dowel and Sleeve Set

- ◆ 2 in one, high resistance to torsion and dowel pull out.
- ◆ Never loosen through time and ensure rigid construction.

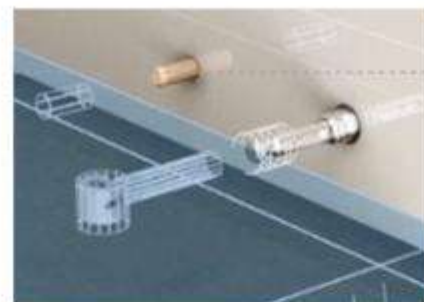

Hardwood Dowel

- ◆ Sturdy and long lasting, Ø8*30mm



Adjustable Leg

- ◆ Made from PP, each leg to bear 100KG weights, more than 20 years of service life.
- ◆ Leg length can be 80mm, 110mm, 130mm and 160mm.

CARCASE HARDWARE



Suspension Bracket Invisible

- ◆ HETTICH suspension bracket, 110KG loading capacity/set, durable and safe



Suspension Bracket Visible

- ◆ Made from nickle plated steel/ABS and withstanding 24hrs of salt test.
- ◆ Patented locking design to keep cabinets from slipping off.
- ◆ 65KG/pc powerful loading capacity.



Aluminum Crossbar

Instead of wooden crossbar, OPPEIN base units are mounted with aluminum crossbar, which can greatly reinforce the cabinet structure, support and protect your countertop.



Idle Hole Insert

- ◆ Made from food-grade plastic.
- ◆ Various colors optional to be harmonious with carcase interiors.
- ◆ To avoid moisture entry into holes.



Kpush-Tech Door Rebounder

- ◆ From ITALIANA FERRAMENTA, withstanding 80,000 fatigue tests.
- ◆ Perfect new silent automatic opening system for doors without handles or knobs.



Hettich/blum Hinges

- ◆ Made from stainless steel, nickle finished, or zinc alloy.
- ◆ Withstanding 200,000 cycle tests, to allow silent motion due to the mute dampener.



Cobra Glass Shelf Pin

- ◆ From ITALIANA FERRAMENTA, zinc alloy material, nickle finished, enhances the look of your cabinets.
- ◆ Nylon screw to allow to lock the glass shelf safely in place.



Waterproof Kickboard and Clips

- ◆ Kickboard made from aluminum, plastic or wood.
- ◆ Colors can be white, grey, black, silver, or wood grain colors to match your cabinets.
- ◆ High quality plastic fasten kickboards with adjustable legs tightly.



Rubber Buffer

- ◆ Mounted on door fronts to offset impact when door closing.
- ◆ To protect door fronts and avoid noise.



Wall Mounting Fitting

- ◆ German FISHER screw and anchor.
- ◆ Withstanding 24 hours of salt test, rustless and corrosion resistant.
- ◆ To keep wall units firm fastened, loading capacity of each anchor ≥800N.

CARCASE HARDWARE



Aluminum Foil Of Sink Cabinet

- ◆ Bottom panel of sink cabinet is coated with aluminum foil, and edges are sealed with waterproof strip inserts, which keep cabinet from absorbing water.
- ◆ Aluminum foil has stylish looks and easy to clean.



22mm Gap Between Backpanel And Wall

3mm thick MDF back panel is inserted into the groove of side panels, a 22mm thick gap are left between protruding side panels and back panels allows air ventilation, and thus back panels will not absorb moisture from wall, will not swell and ensure long service life.



Ventilation Grill

Stainless steel, installed in stove cabinet to keep cabinets ventilation.



Waterproof Strip Insert

Waterproof strips are inserted in the edges of sink cabinet to keep particle board from absorbing moisture.



Undersink Aluminum Supports And Rails

- ◆ Under the sink, 10pcs of aluminum supports are arranged, which help support the weights and impacts evenly from sink and protect your countertops.
- ◆ Also, 3 pcs of aluminum rails are installed on the back side to offset the weights from worktop evenly.

DOOR FRONTS



Solid Wood

- ◆ Genuine broadleaf wood imported from North America, with rich, natural and clear wood grain, stunning linear texture
- ◆ 6 popular wood species optional including birch, cherrywood, alder, oak, ash and walnut.
- ◆ 8-12% moisture rate, not liable to distort or rupture
- ◆ Outstanding bending resistance; High scratch resistance and intensity.
- ◆ Good workability, sleekly section, good water resistance and adhesion performance.
- ◆ Lumber supplied by MATSON LUMBER COMPANY and GUTCHESS LUMBER, both are the world's best hardwood manufacturers in North America.
- ◆ Segment: premium



Lacquer

- ◆ 18/21/25mm thick MDF as core
- ◆ Eco-friendly lacquer are supplied by PPG and DAIHO, both are paint industry leaders in the world
- ◆ Superior yellowing resistance and weatherability to avoid discolor.
- ◆ Hardness is as high as 1.8, bringing outstanding scratch resistance.
- ◆ Matt or high gloss surface optional.
- ◆ Metallic lacquer optional, which is added silver powder to get metallic shiny surface.
- ◆ Segment: high and middle-end.



PVC Foil Coated

- ◆ 18/21/25mm thick MDF as core, seamless frame and core structure
- ◆ Front face coated with PVC, back face coated with white melamine
- ◆ PVC foils are supplied by RIKEN and RENOLIT, both are world-leading decor foil manufacturer High quality PVC foil, mainly supplied by Renolit and Riken
- ◆ Applying JOWAT eco-friendly glue
- ◆ Fine and beautiful wood grain
- ◆ Tough surface, superior scratch resistance
- ◆ Alternative for genuine wood



PP Foil Coated

- ◆ 21/25mm thick MDF as core
- ◆ Frame and core structure, both faces coated with PP foil
- ◆ PP foil has astonishingly excellent wood grain and texture, and it is the best alternative for genuine wood
- ◆ Classical looks same as genuine wood, but with outstanding price performance
- ◆ Segment: high and middle-end

DOOR FRONTS



Acrylic

- ◆ 18mm thick MDF/particle board as core
- ◆ Front face coated with inked acrylic, back face same as front face, or laminated with ABS décor paper
- ◆ Edges sealed with same color acrylic
- ◆ Scratch resistant and easy care
- ◆ Excellent alternative for lacquer
- ◆ Segment: middle-end and economical



High Pressure Laminate

- ◆ 18mm thick particle board as core
- ◆ Edges sealed with 2mm thick REHAU PVC
- ◆ The decorative paper is 0.6–0.8mm thick, outstanding scratch and heat resistance
- ◆ Scratch resistant and easy care
- ◆ Segment: economical



Melamine

- ◆ 18mm thick particle board as core
- ◆ Edges sealed with 2mm thick REHAU PVC
- ◆ Both faces coated with high quality German SCHATTDECOR or SPAIN LAMIGRAF impregnated décor paper
- ◆ Natural colors or monocolors optional, fine texture
- ◆ Scratch resistant and easy care
- ◆ Segment: economical

COUNTERTOP



Caesarstone

- ◆ Imported from Israel.
- ◆ Eco-friendly and nonporous material.
- ◆ Scratch and wear resistant, antibacterial and easy to clean.
- ◆ Made of quartz, requiring minimal maintenance, no need to seal or wax, heat and aging resistance.



Counter Processing

- ◆ Countertop processed by imported Germany sophisticated machines.
- ◆ Slab precisely cut by advanced laser bridge cutting machine, tolerance within 0.5mm.
- ◆ High efficient water-jet CNC cutting machine used for cutting, hole boring and irregular profile moulding.
- ◆ Countertop profile moulded and polished by imported CNC center, insuring precise and high quality.



Silestone

- ◆ Imported from Spain. Made up of 94% natural quartz
- ◆ Hard and resilient, stain resistant, acid resistant, scratch resistant and heat resistant
- ◆ Impact resistant, bacteriostatic protection, can contact with food directly. Beautiful textures, high-end



Undermount Technics

- ◆ Dupont green glue used to fix sinks, 14 scientific progresses.
- ◆ No annoying glue residues, sleek and easy cleaning.
- ◆ Extra cross bars are in position to avoid possible countertop splitting or distortion.
- ◆ The bearing capacity is twice that of topmount.



Oppein Quartz Stone

- ◆ Outstanding scratch & impact resistance performance.
- ◆ Non-porous and highly stain-resistant to stains, such as wine, vinegar oil.
- ◆ Flame retardant, heat resistance (as high as 300°)
- ◆ Superior aging resistance; Nontoxic and no radiation.
- ◆ Minimal maintenance



Aluminum Cross Bars

- ◆ 3 horizontal aluminum bars are smartly designed to bear the weight from countertop equally, avoiding possible countertop splitting or distortion caused by uneven weight.
- ◆ Especially, at the back side of stove opening and sink opening, extra aluminum bars are in position to equally absorb countertop weight.

ERGONOMIC PLANNING

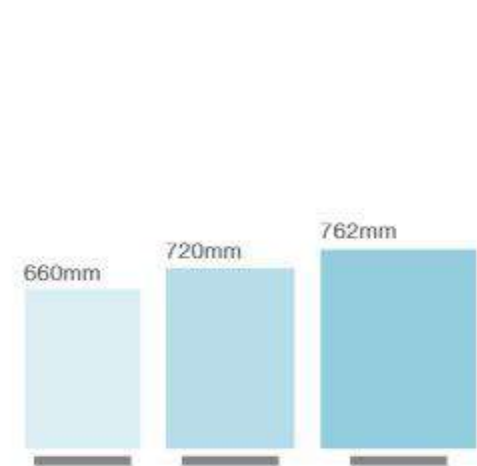

3 Heights Of Base Units

Multiple height choices, suitable for people with different heights.

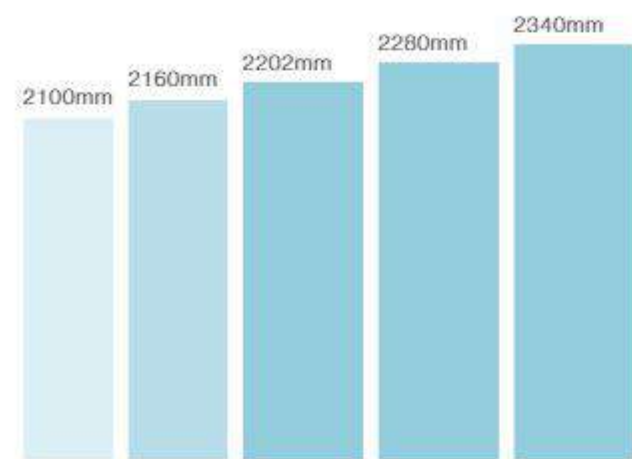

5 Heights Of Pantry

Can be chosen freely, matching with multiple pull-outs, make reasonable use of high cabinet space. Ingenious design hides the appliance skillfully and keep the kitchen style unified.

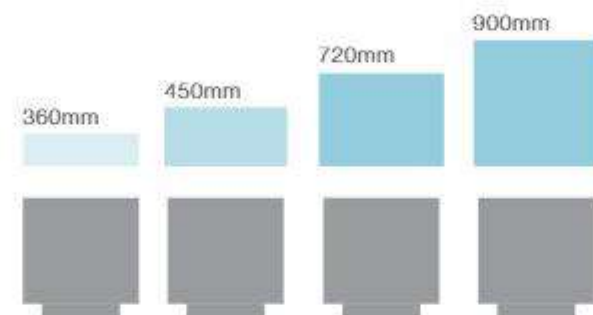

4 Heights Of Wall Units

Accurate and user-friendly height, make good use of the upper space, matching with step ladder, easy to access. Optional concealed handle, can avoid knock against efficiently.

ERGONOMIC PLANNING

The basic rule of kitchen triangle is applied in each OPPEIN kitchen design. The primary task in a kitchen are carried out between the cook top, the sink and the refrigerator.

These three points and the imaginary lines between them make up what kitchen experts call the work triangle. The idea is that when these three elements are in close (but not too close) proximity to one another, the kitchen will be easy and efficient to use, cutting down on wasted steps.

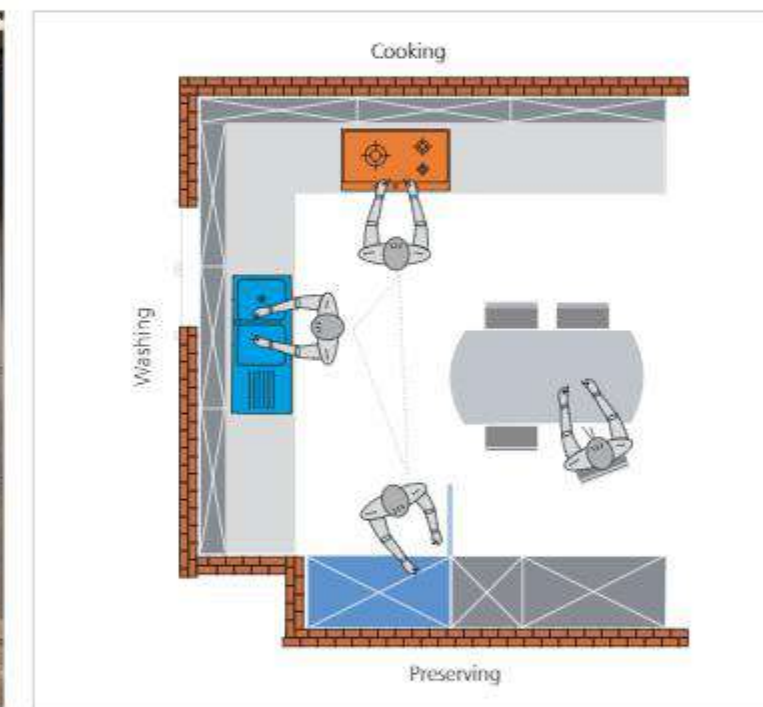

WALL FUNCTIONAL FITTINGS



Aventos HF With Servo-drive

AVENTOS HF works with two-part, bi-fold doors that fold in the center when opening. It is an ideal solution for tall wall cabinets with large doors because the handle stays within easy reach. With Servo-drive, doors can be opened with a simple touch, and a press of the switch ingrained into the carcass side panel, door closed again.



Aventos HS

AVENTOS HS lift systems open doors up and over the top of the cabinet, and they are ideal for wide cabinets with heavy, single doors.



Aventos HK-XS

AVENTOS HK-XS is a smaller, cost-effective lift system for shallow wall cabinets, like those above refrigerators and pantries. Its variable stop feature allows the door to stay in any desired position, so it's always within reach.



Aventos HK-S

With AVENTOS HK-S lift systems, you get the same operation of AVENTOS HK, but in a smaller package. These lift systems have been specifically designed to snugly fit in smaller cabinets, and they excel above refrigerators and pantries.



Aventos HL With Servo Drive

AVENTOS HL lift single doors parallel to the cabinet. It works great in kitchens with high ceilings, and crown molding will not be a problem because of the motion of the door. AVENTOS HL is also an ideal solution for a counter top appliance garage.

MAGIC STORAGE SYSTEM

Base Units

Everybody wants to have more storage in the kitchen. By reasonable layout, OPPEIN magic storage system can improve your storage space by 30%. Everything will find its place, no space is wasted.



MAGIC STORAGE SYSTEM

Pantry Units

No matter tandem or pull outs, our pantry pull outs always make best use of available space, and supports good organization and fast access. All the contents, even on the topmost shelf, are in clear view. Meanwhile, the built-in damping system can keep operation noiseless.



MAGIC STORAGE SYSTEM

Wall Units

Pull down the pull outs, you can easily access your storage in the wall or top of the high pantry. Still, the optimal layout makes full use of the space and makes storage tidy.



MAGIC STORAGE SYSTEM



Drawer Interior

The clever design of these drawer dividers means you can easily adjust them as you add and remove items from the drawers, keeping the contents upright, accessible and tidy.

Drawer dividers ensure you get the best possible use of the drawer space. No more clutter. The kitchen drawer dividers also simplifies preparation of your shopping list.



LIGHTING SYSTEM

Different types of down lights, strip lights and shelf lights, drawer lights and inductive lights offer not only additional illumination, but also create a happy mood in your kitchen. Our lights are harmonious with your kitchen space, and high quality LED strips or bulbs allow long service life and bring energy saving.



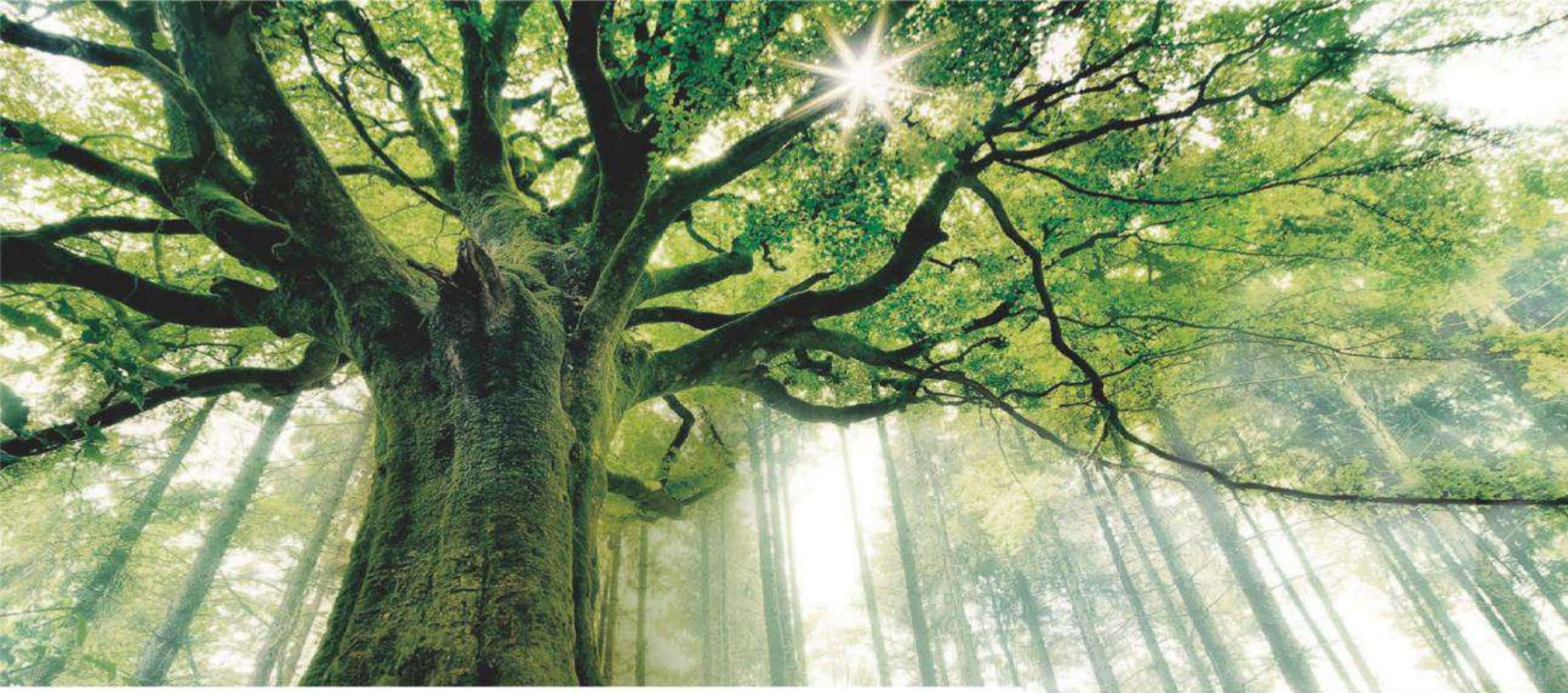

Quality Control

All our panels comply with emission class E1, pass tests with European chamber method EN717-1, and meet the stringent California Air Resources Board (CARB) emissions standards. Silestone, Caesarstone and other imported quartz stone are all Greenguard certified. And OPPEIN self-manufactured quartz stone is NSF certified.

CONTROL OF HAZARDOUS SUBSTANCES

Panels and Paints

Substances Test Standards Material	Formaldehyde Emission					Soluble Pb	Soluble Cd	Soluble Cr	Soluble Hg	Soluble Methanol
	China GB18584-2001	EU EN717-1:2004	USA/ASTM D 6007:2014	Japan JIS A 1460:2015	Australia AS/NZS 4266.16:2004					
MDF	≤1.5mg/L	≤0.124mg/m³	≤0.13ppm	≤0.3mg/L	≤0.5mg/L	—	—	—	—	—
Particle board	≤1.5mg/L	≤0.124mg/m³	≤0.09ppm	≤0.3mg/L	≤0.5mg/L	—	—	—	—	—
Plywood	≤1.5mg/L	≤0.124mg/m³	≤0.05ppm	≤0.3mg/L	≤0.5mg/L	—	—	—	—	—
Test Conclusion	Compliant	Class E1 compliant	Compliant	F4 compliant	Class E0 compliant	≤90mg/kg	≤75mg/kg	≤60mg/kg	≤60mg/kg	≤500mg/kg

Countertops

Material Type	Item Value	Internal exposure index (IRa)	External exposure index (Ir)	Median lethal dose (LD50)
OPPEIN quartz stone		≤0.6	≤0.8	□15000mg/kg
Solid surface		≤0.6	≤0.8	□15000mg/kg
Imported quartz stone		≤0.6	≤0.8	□15000mg/kg

Adhesives

Material Type	Item Value	Free formaldehyde	Benzene	Methylbenzene & dimethylbenzene	Halohydrocarbon	TVOC
Adhesives		≤100mg/kg	≤100mg/kg	≤500mg/kg	≤500mg/kg	≤50g/L

QUALITY CONTROL



FSC Certification

FSC is a forest certification, aims at promoting global responsible forest management. Our panels come from sustainably managed forests and controlled sources. Forest certification provides the guarantee that the wood products you purchase do not derive from questionable sources or over-exploitation, but rather originate from forests that are managed in harmony with nature.



CARB Certification

Formaldehyde is produced on a large scale worldwide. One major use includes the production of wood binding adhesives and resins. In 2009, the California Air Resources Board (CARB) released the toughest formaldehyde emission regulations for composite wood products. OPPEIN takes formaldehyde emissions very seriously and all panels we purchase CARB-certified.



5 Years Limited Warranty

Cabinets manufactured by OPPEIN HOME GROUP are warranted to be free from defects in material and workmanship under normal use to the original consumer purchaser for a period of five years from the date of purchase.



NSF Certification

Our quartzstone is endorsed by the National Health and Safety Foundation (NSF) in accordance with international NSF 51 sanitary standards, and they are qualified for installation in hospitals, restaurants, hotels and more.

QUALITY CONTROL

We oversee every process that affects quality, such as:

- ◆ Supplier selection and assessment
- ◆ The quality of raw material, spare parts and finished products
- ◆ Product design and development
- ◆ Shipment and installation
- ◆ Documentation management

Every year, OPPEIN conducts more than 500 tests in its well-equipped test labs and the third party testing bodies.



Yellowing Tester



Salt Spray Tester



Constant Temperature and Humidity Chamber

KITCHEN CABINET PACKING

PRE-ASSEMBLED PACK



STEP 1

Wrap each cabinet completely with EPE film, no exposures.



STEP 2

Fix EPE film with blue tapes.



STEP 3

Protect edges with cardboard edge protectors.



STEP 4

Tightly wrap the cabinet with stretch film.



STEP 5

Label the cabinet with shipping mark.



STEP 6

Stack pre-assembled units orderly from one side to another side. Packed units must NOT exceed pallet boundary.



STEP 7

In order to keep the stacks stable, make sure the stack height is less than 2350mm (including the pallet height).



STEP 8

Cover the 4 side edges with cardboard edge strips, then fix it with tape.



STEP 9

Tightly wrap all units with stretch film.



STEP 10

Cover the top edges with cardboard edge strips, then fix them with tape.



STEP 11

Tighten the palletized units with plastic bolts. 4 bolts in horizontal direction and 2 bolts in vertical direction.



STEP 12

Label the pallet with shipping mark. The shipping mark can be specified.

KITCHEN CABINET PACKING

FLAT PACK

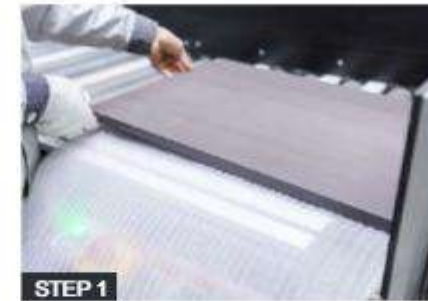

STEP 1

Wrap each panel with EPE foam, no exposures



STEP 2

Cover each panel with honeycomb paper

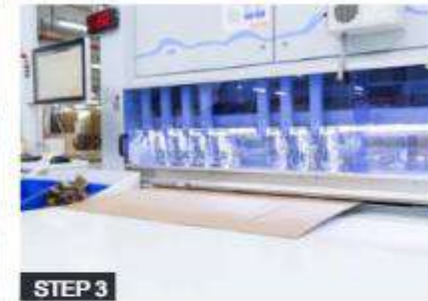

STEP 3

Cut carton based on panel dimensions



STEP 4

Protect each panel with edge protectors.

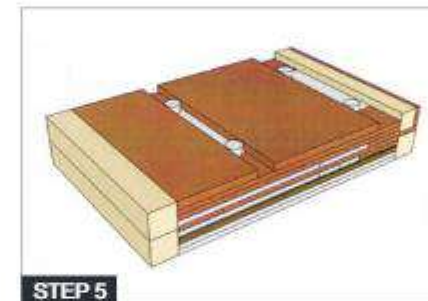

STEP 5

Stack packed panels into eight layers; and place the slide box at the left side and hardware box at the right side.



STEP 6

Cover the stack with carton and label it.



STEP 7

Tighten the carton with belts

COUNTERTOP PACKING



STEP 1

Check the countertop according to the drawing



STEP 2

Cut slats to size according to the countertop size. The longer pieces will be the sides of your crate and the shorter boards will be the ends.



STEP 3

Encompass the countertop with slats and attach them with a nail gun.



STEP 4

Stick the label on one slat.



STEP 5

Cover the countertop with foam boards.



STEP 6

Pack glue bottles and the backplash.



STEP 7

Attach front rails to side slats with the nail gun.



STEP 8

Turn the countertop and box over, then fill the back voids with foam boards.



STEP 9

Attach back rails to side slats with the nail gun.



STEP 10

Enclose the sink with slats and attach the 4 slats with the nail gun.



STEP 11

Nail the metal corners onto side slats.



STEP 12

Make sure the package is stable.